

365 Residential

**CHESTNUT DRIVE,
Soham**



- Well Presented
- 2 Double Bedrooms
- Spacious living room
- Allocated parking
- Ground Floor Apartment
- Double Glazed
- Quiet location
- Viewings 9am-9pm 7 days a week



**Chestnut Drive
Soham**

£675pcm

AVAILABLE 01/09/2022. A 2 Bedroom Ground Floor Apartment Tucked Away In A Desirable Cul De Sac In Soham. 2 Bedrooms, Modern Bathroom, Kitchen, Living Room, Allocated Parking Space. Viewings 9am-9pm 7 Days A Week.

Communal Entrance

Communal Entrance Front door leading to inner doors and front door to flat, there is an intercom entrance system.

Hall

Carpeted flooring, front door, further doors leading to, airing cupboard, Bedrooms, Bathroom, Lounge/Diner and Kitchen.

Lounge/Diner 14' 3" x 12' 3" (4.34m x 3.74m)

Box bay window to rear, TV point, carpeted, electric storage heater, open to Kitchen and door leading back to Hallway.

Kitchen 11' 3" x 5' 11" (3.44m x 1.80m)

Range of low and high-level units, sink with mixer taps, laminate worktops, vinyl tile effect flooring, plumbing for washing machine, open to Lounge/Diner and window to the rear.

Bathroom 6' 8" x 6' 4" (2.04m x 1.92m)

Vinyl flooring, White 3-piece suite comprising W/C, sink and bath with shower over and partly tiled walls.

Bedroom 1 12' 3" x 9' 9" (3.74m x 2.96m)

Window to the front aspect, carpeted, and electric storage unit.

Bedroom 2 10' 11" x 8' 10" (3.34m x 2.70m)

Window to front, carpeted and electric storage unit.

Outside

Residents allocated parking.

19 Chestnut Drive, Soham, CB7 5FW

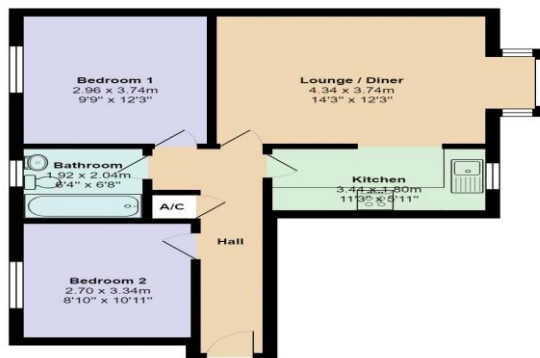

Total Area: 58.6 m² ... 631 ft²

All measurements are approximate and for display purposes only

